

32mm double glazed unit comprising of:
 6mm clear toughened outer pane
 18mm Argon filled cavity
 8.8mm clear float laminated low 'e' inner pane

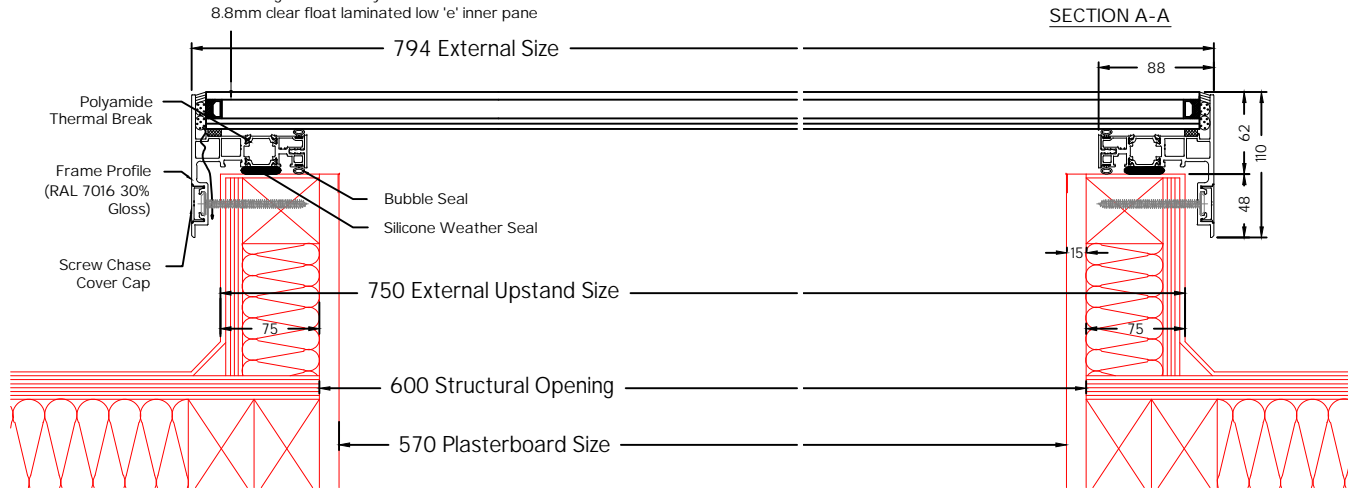

FIXED
 600x600mm

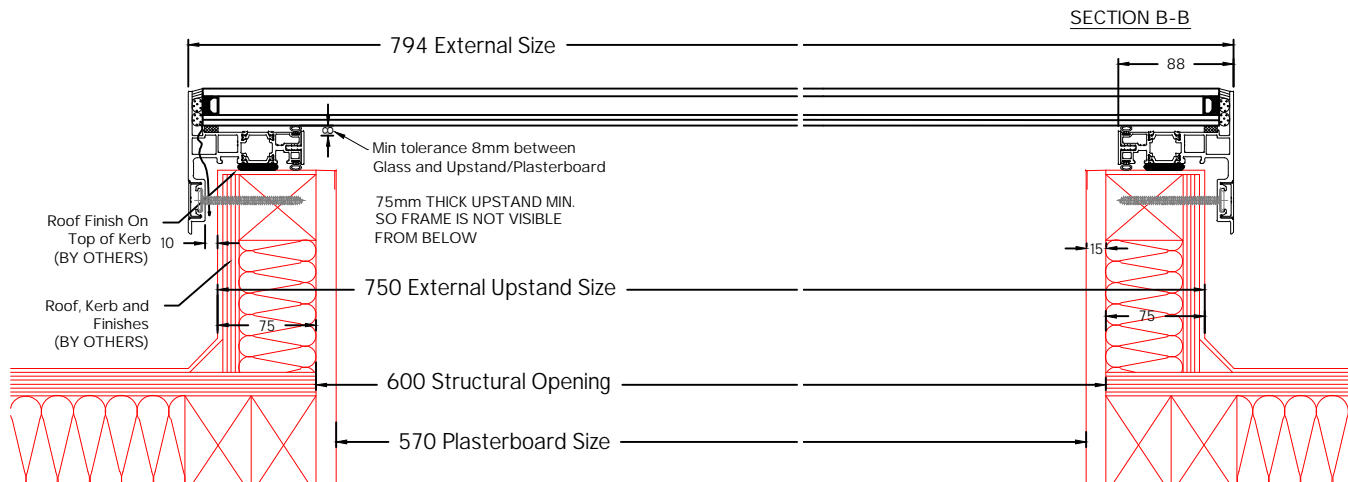
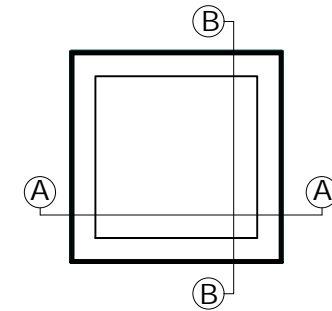

Key:
 — by others
 — by EOS

Recommended Upstand Detail

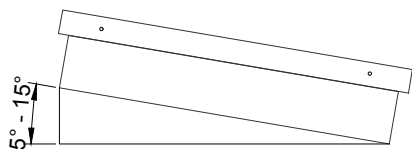
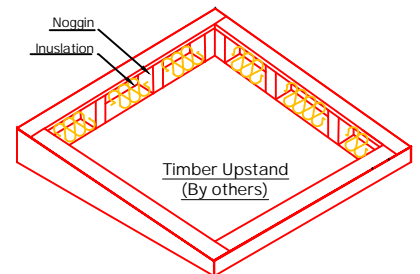

Rooflight must be installed on a roof pitch between 5-15° (by others). Failure to do so will result in water pooling on the rooflight.



Title:
 Lite Double Glazed Fixed Rooflight - Lid Only (For Builders Upstand)

System: Lite	Size: 600mm x 600mm	Type: Fixed	Ref: ST29
-----------------	------------------------	----------------	--------------



Scale:
1:4 @ A3

Date:
Jan 21

0
revision