

36mm double glazed unit comprising of:
 8mm clear toughened outer pane
 14mm Argon filled cavity
 11.5mm clear float laminated low 'e' inner pane

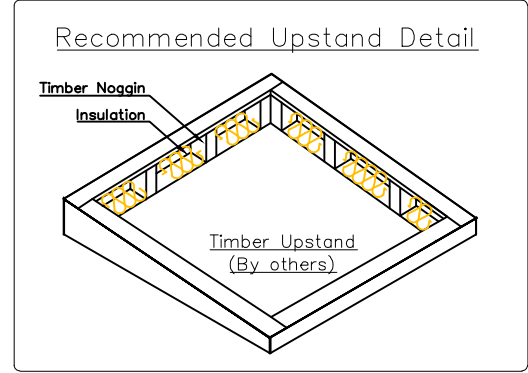
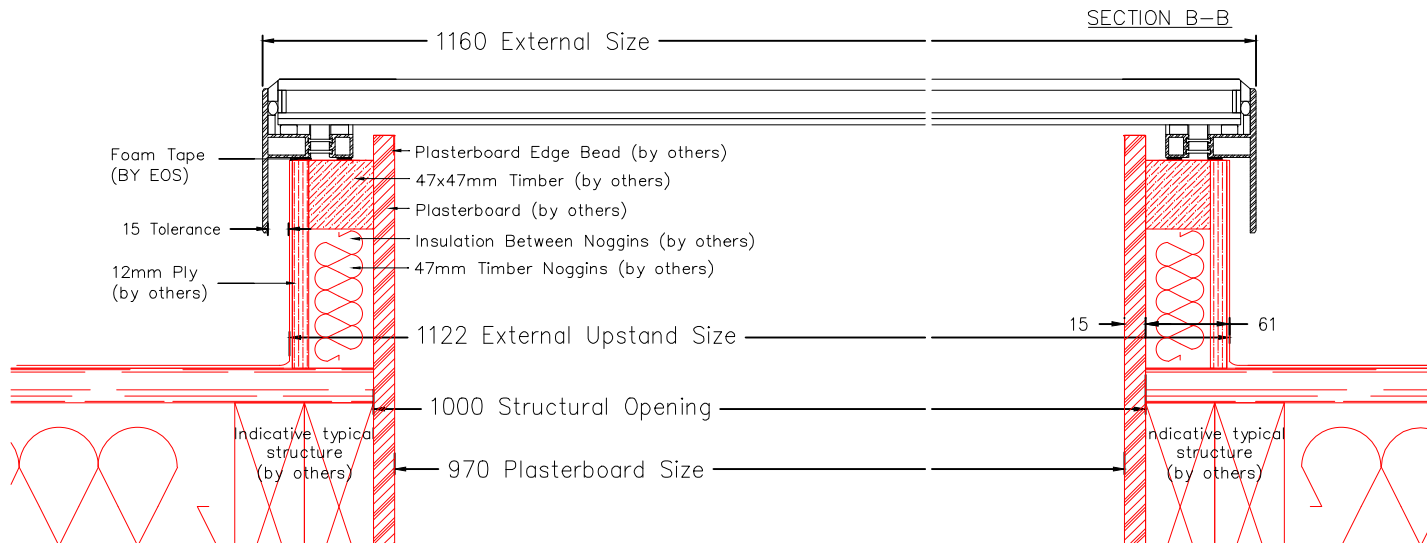
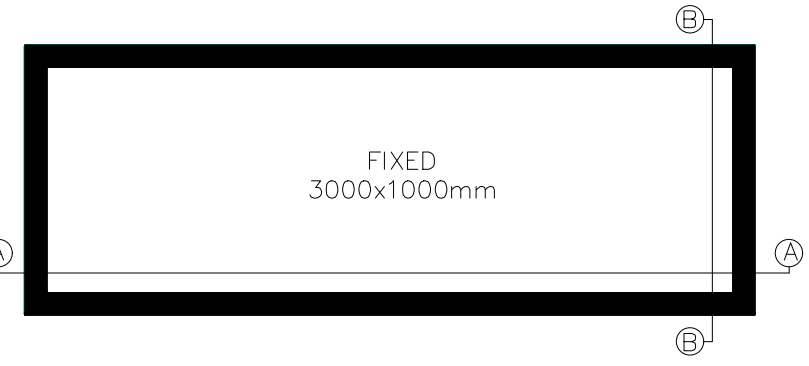
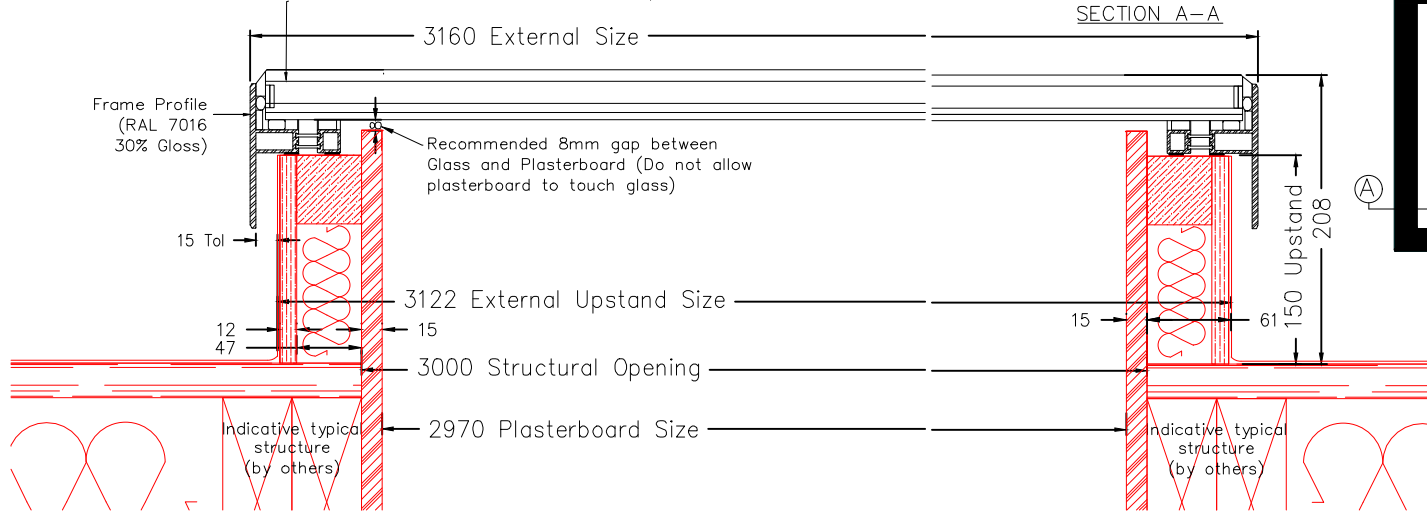

5° - 15°

Rooflight must be installed on a roof pitch between 5-15° (by others). Failure to do so will result in water pooling on the rooflight.

Key:
 — by others
 — by EOS



Drawing Title:
 3000x1000mm
 Fixed Rooflight

Scale:
 1: 4 @ A3

Drawing No.:
 F16

Date:
 Feb '20

revision
 0