

FIXED
2400x600mm

31mm double glazed unit comprising of:
8mm clear toughened outer pane
14mm Argon filled cavity
8.8mm clear float laminated low 'e' inner pane

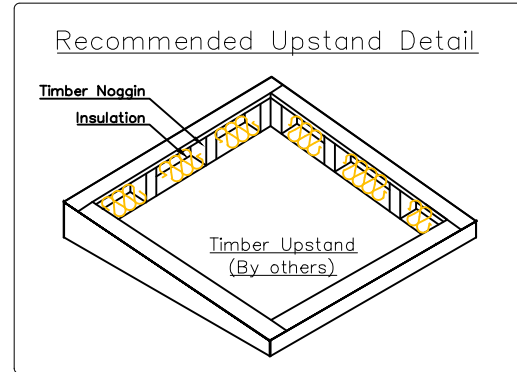

5° - 15°

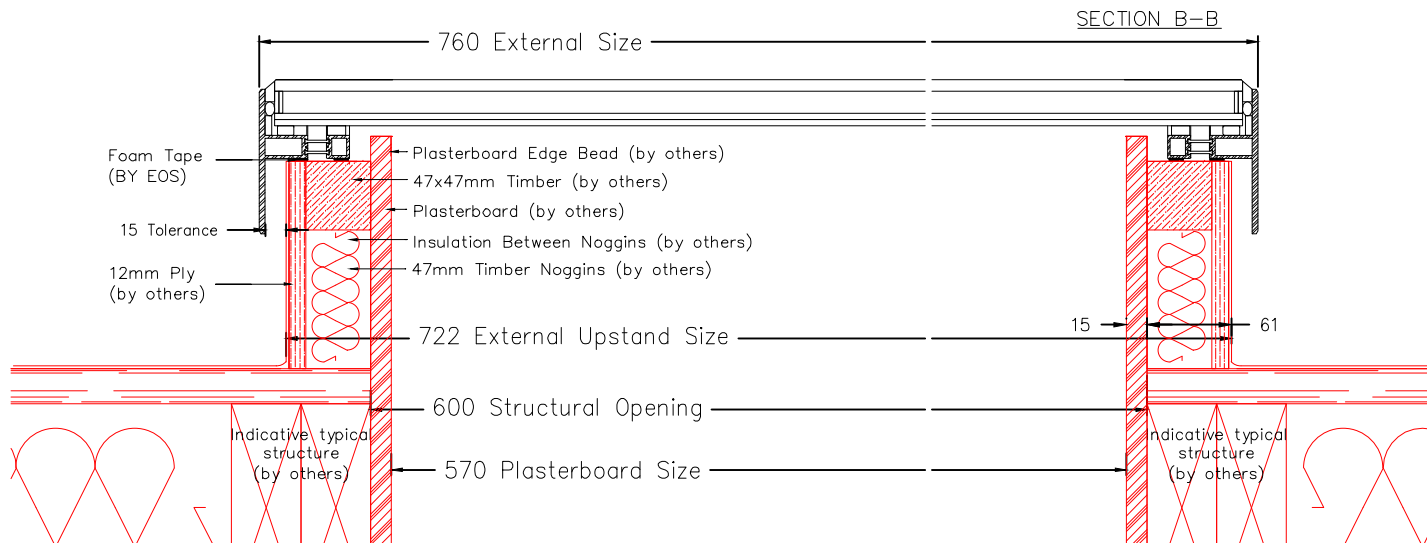
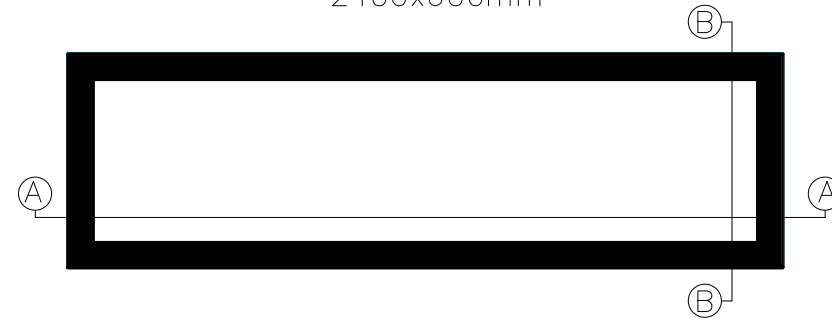
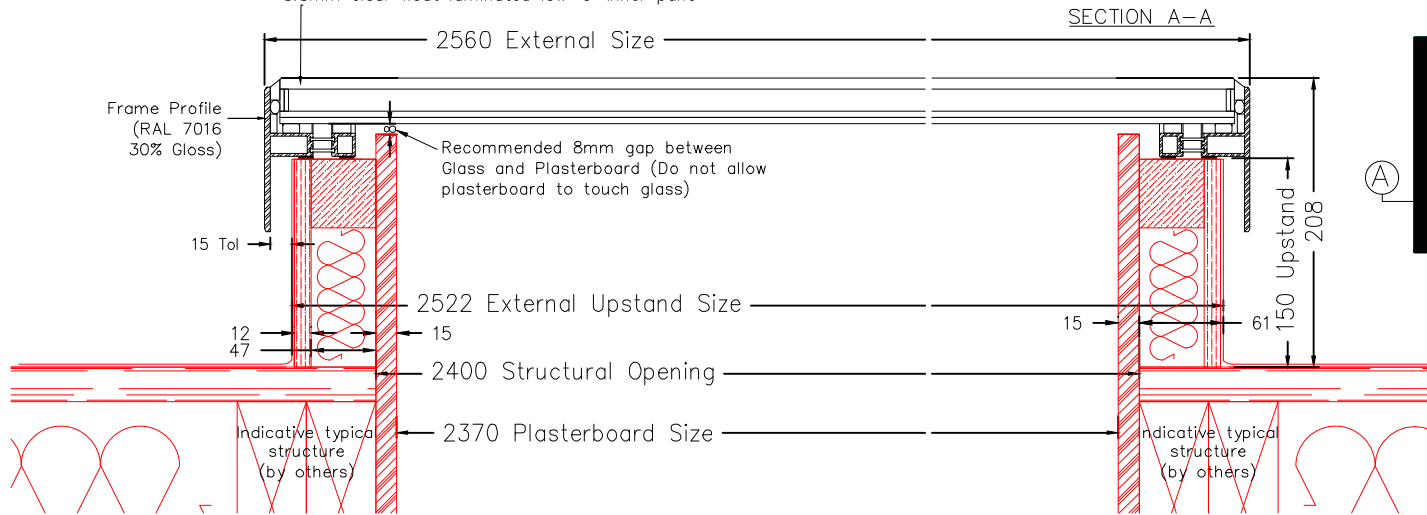
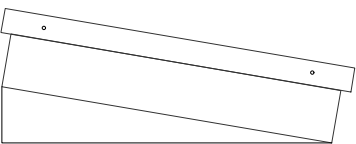

Rooflight must be installed on a roof pitch between 5-15° (by others). Failure to do so will result in water pooling on the rooflight.



Key:
— by others
— by EOS



Drawing Title:
2400x600mm
Fixed Rooflight

Scale:
1: 4 @ A3

Drawing No.:
F15

Date:
Feb '20

0
revision